

# GOLDEN 4 TRACK 60K ELEVATOR LIFT

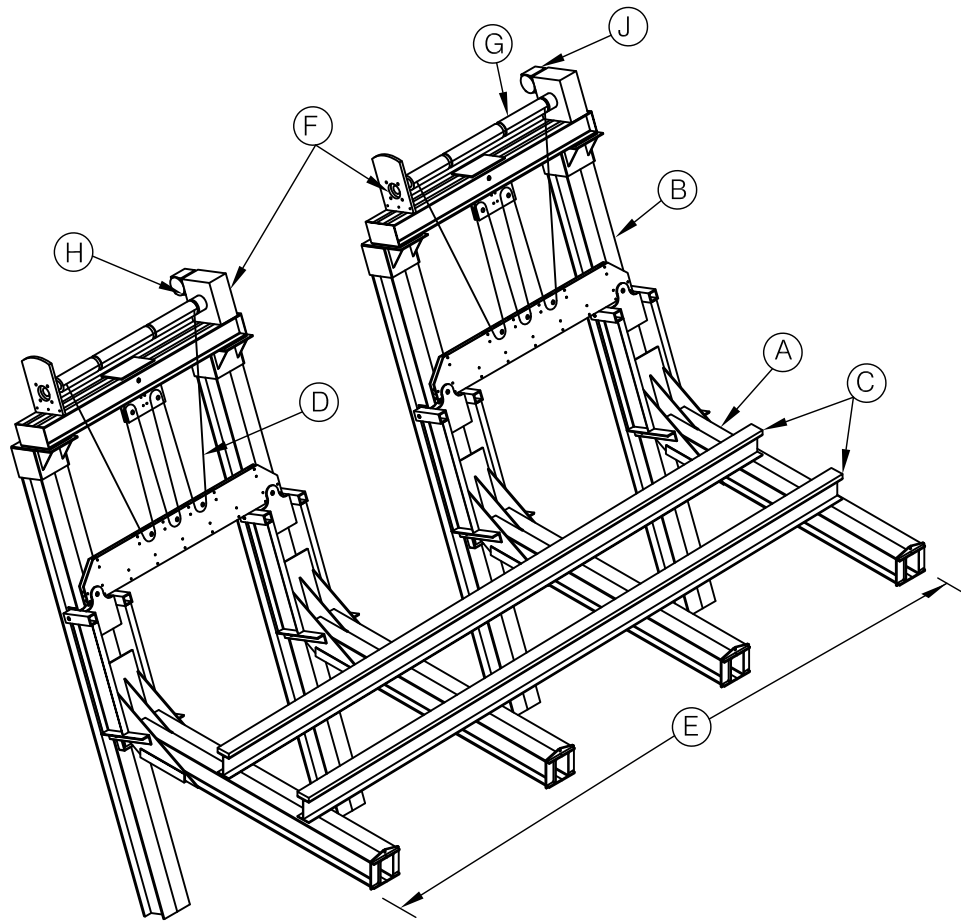

INCLINE MOUNT OR VERTICAL MOUNT

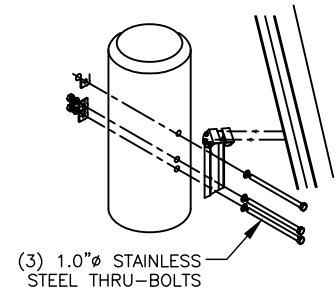

(3) 1.0"Ø STAINLESS STEEL THRU-BOLTS

TYPICAL VERTICAL CONNECTION TO WOOD PILE OR HORIZONTAL WOOD DECK FRAMING

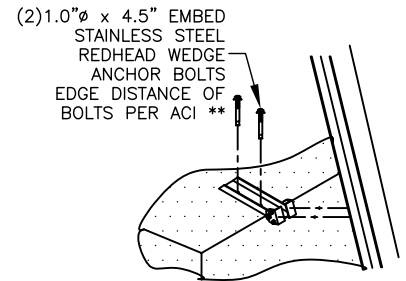

(2) 1.0"Ø x 4.5" EMBED STAINLESS STEEL REDHEAD WEDGE ANCHOR BOLTS  
EDGE DISTANCE OF BOLTS PER ACI \*\*

TYPICAL HORIZONTAL CONNECTION TO REINFORCED CONCRETE DOCK OR SEAWALL

NOTE: THIS STRUCTURE HAS BEEN DESIGNED FOR LOADS ASSOCIATED WITH AN ULTIMATE WIND SPEED OF 180 MPH, EXPOSURE "D", RISK CATEGORY I, CALCULATED PER FLORIDA BUILDING CODE 2020, ASCE/SEI 7-16 AND ADM-2015. BOATS SHALL NOT BE STORED ON LIFTS DURING HIGH WIND EVENTS. ALL PRIMARY STRUCTURAL MEMBERS ARE TO BE 6061-T6 ALUMINUM. TRACKS ARE TO BE DRIVEN TO FIRM BEARING MATERIAL.

## SUMMARY OF DESIGN FEATURES

	(A)	(B)	(C)	(D)	(E)	(F)	(G)	(H)	(J)		
LIFT CAPACITY	CRADLE I-BEAM	TRACK I-BEAM	BUNK BOARDS	CABLE SIZE	TRACK SPREAD	BRGS	WINDER DIA	GEAR RATIO	MOTOR HP/VOLTAGE	INCHES OF LIFT PER MIN.	GUIDE POST HEIGHT
60,000#	(4) DOUBLE 12 H x .31 7 W x .62 x 14' LG. @ 14.3#/FT	(4) DOUBLE 12 H x .31 7 W x .62 x 30' LG. @ 14.3#/FT	(2) 10 H x .25 6 W x .41 x 25' LG. CAPPED W/ WOOD & CARPET	(2) 5/8"Ø x 102' S.S. 6 PART	8' THRU 14'	(2) PILLOW BLOCK	SEA DRIVE: 6"Ø SOLID ALUMINUM WINDER	500:1	(2) 5 HP 120V/20A 240V/10A	7.86"	120"