

GOLDEN ELEVATOR LIFT

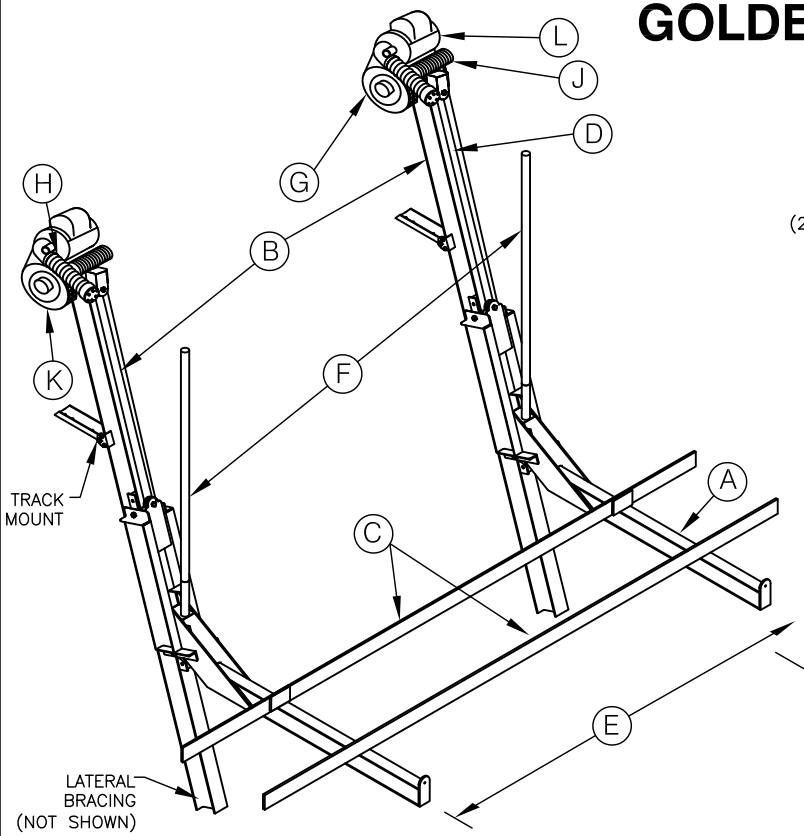

(2) 3/4"Ø x 3-1/4" LG.
STAINLESS STEEL
REDHEAD WEDGE
ANCHOR BOLTS
EDGE DISTANCE OF
BOLTS PER ACI **

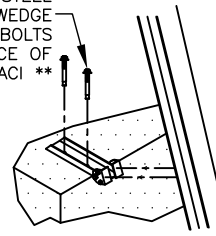

** ON 40K LIFT USE
(2) 1" DIA. x 4-1/2" EMBED

TYPICAL HORIZONTAL
CONNECTION TO REINFORCED
CONCRETE DOCK OR SEAWALL

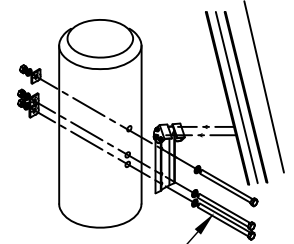

(3) 3/4"Ø STAINLESS
STEEL THRU-BOLTS

TYPICAL VERTICAL
CONNECTION TO WOOD
PILE OR HORIZONTAL
WOOD DECK FRAMING

INCLINE MOUNT OR VERTICAL MOUNT

NOTE: THIS STRUCTURE HAS BEEN DESIGNED FOR LOADS ASSOCIATED WITH AN ULTIMATE WIND SPEED OF 180 MPH, EXPOSURE "D", RISK CATEGORY I, CALCULATED PER FLORIDA BUILDING CODE 7th EDITION, 2020, ASCE/SEI 7-16 AND ADM-2015. BOATS SHALL NOT BE STORED ON LIFTS DURING HIGH WIND EVENTS (GREATER THAN 75 MPH). ALL PRIMARY STRUCTURAL MEMBERS ARE TO BE 6061-T6 ALUMINUM. TRACKS ARE TO BE DRIVEN TO FIRM BEARING MATERIAL AND SHALL BE SPACED HORIZONTALLY WITHIN THE LIMITS OF TRACK SPREAD "E". TRACKS SHALL BE ADEQUATELY BRACED LATERALLY FROM TRACK TO TRACK WHEN DISTANCE BETWEEN THE TRACK MOUNT AND SEA FLOOR IS 9 FT. OR GREATER. LATERAL BRACES SHALL BE SPACED AT NO MORE THAN 8 FEET APART. FOR LIFTS WITH DISTANCE FROM TRACK MOUNT TO SEA FLOOR LESS THAN 9 FEET, LATERAL BRACING IS NOT REQUIRED.

SUMMARY OF DESIGN FEATURES

	(A)	(B)	(C)	(D)	(E)	(F)	(G)	(H)	(J)	(K)	(L)	
LIFT CAPACITY	CRADLE I-BEAM	TRACK I-BEAM	BUNK BOARDS FEET	CABLE SIZE	TRACK SPREAD	GUIDE POST HEIGHT	BRGS	DRIVE SHAFT	WINDER DIA	GEAR RATIO	MOTOR HP/VOLTAGE	INCHES OF LIFT PER MIN.
3,000#	(2) 8 H x .23 5 W x .35 x 8' LG. @ 6.18#/FT	(2) 8 H x .23 5 W x .35 x 25' LG. @ 6.18#/FT	(2) 2 x 8 x 144 ROUGH SAW CARPETED	(2) 5/16"Ø x 30' S.S. 2 PART	7' THRU 10'	80'	(4) 2" EXTRUDED 6061-T6 ALUM	(2) 1.900" O.D. x .148" WALL GALVANIZED HSS	FLAT PLATE DRIVE: 3"Ø O.D. X 1.99" I.D. SEA DRIVE: 3.5"Ø O.D. X 1.99" I.D.	480:1	(2) 3/4 HP 120V/20A 240V/10A	13-1/2"
5,000# & 7,000#	(2) 8 H x .25 5 W x .41 x 8' LG. @ 7.02#/FT	(2) 8 H x .25 5 W x .41 x 25' LG. @ 7.02#/FT		(2) 5/16"Ø x 30' S.S. 2 PART							(2) 3/8"Ø x 30' S.S. 2 PART	
10,000#	(2) 9 H x .27 5.5 W x .44 x 8' LG. @ 8.36#/FT	(2) 9 H x .27 5.5 W x .44 x 25' LG. @ 8.36#/FT		(2) 3/8"Ø x 30' S.S. 2 PART	8' THRU 11'						(2) 3/4 HP 120V/20A 240V/10A	
12,000#	(2) 10 H x .25 6 W x .41 x 8' LG. @ 8.65#/FT	(2) 10 H x .25 6 W x .41 x 25' LG. @ 8.65#/FT	(2) 3 x 10 x 192 ROUGH SAW CARPETED	(2) 3/8"Ø x 45' S.S. 3 PART	120'	14'	(2) 1.900" O.D. x .165" WALL GALVANIZED HSS	FLAT PLATE DRIVE: 3"Ø O.D. X 1.99" I.D. SEA DRIVE: 3.5"Ø O.D. X 1.99" I.D.	480:1	(2) 1 HP 120V/20A 240V/10A	9"	
15,000#	(2) 10 H x .29 6 W x .50 x 8' LG @ 10.3#/FT	(2) 10 H x .29 6 W x .50 x 25' LG @ 10.3#/FT		(2) 3/8"Ø x 56' S.S. 4 PART						8' THRU 14'	(2) 1 HP 120V/20A 240V/10A	6.75"
17,000#	(2) 12 H x .29 7 W x .47 x 10' LG. @ 11.7#/FT	(2) 12 H x .29 7 W x .47 x 25' LG. @ 11.7#/FT		(2) 10 H x .25 6 W x .41 x 20' LG. CAPPED W/ WOOD & CARPET						(2) 7/16"Ø x 60' S.S. 4 PART	10' THRU 16'	9"
20,000#	(2) 12 H x .31 7 W x .62 x 11' LG. @ 14.3#/FT	(2) 12 H x .31 7 W x .62 x 25' LG. @ 14.3#/FT	(2) 10 H x .25 6 W x .41 x 20' LG. CAPPED W/ WOOD & CARPET	(2) 1/2"Ø x 68' S.S. 4 PART	10' THRU 16'	14'	(6) 2" EXTRUDED 6061-T6 ALUM	FLAT PLATE DRIVE: 3"Ø O.D. X 1.99" I.D. SEA DRIVE: 3.5"Ø O.D. X 1.99" I.D.	500:1	(2) 1.5 HP 120V/20A 240V/10A	6.75"	
24,000#	(4) 10 H x .29 6 W x .50 x 10' LG. @ 10.3#/FT	(4) 10 H x .29 6 W x .50 x 25' LG @ 10.3#/FT		(2) 1/2"Ø x 68' S.S. 4 PART						GROVE GEAR 842 3.5" Ø O.D. X 1.99" I.D.	6.5"	
30,000#	(4) 12 H x .31 7 W x .62 x 11' LG. @ 14.3#/FT	(4) 12 H x .31 7 W x .62 x 25' LG. @ 14.3#/FT										
40,000#												