



DOCK STABILIZER



FOLLOW US



DOCK STABILIZER: AN INNOVATIVE SOLUTION TO KEEP YOUR DOCK SAFE AND STABLE

The patented Golden Dock Stabilizer was designed to eliminate wobbly and unstable floating docks. Floating docks that are too narrow, aging, or improperly supported can sometimes be unsafe and unstable. The Dock Stabilizer has been proven, once installed, to stabilize and level a floating dock greatly. Results on our first installation were way beyond ours and our client's expectations. The Golden Dock Stabilizer is a game-changer and another innovative idea and product designed, patented, and manufactured by Golden.

FEATURES

- 1) Stabilizes floating docks and wave attenuators
- 2) Minimizes heaving and tilting from wave action
- 3) Customizable to any pile size and type
- 4) Multi-level pile guide with rollers spaced at dock level
- 5) Adjustable to assist in leveling the dock

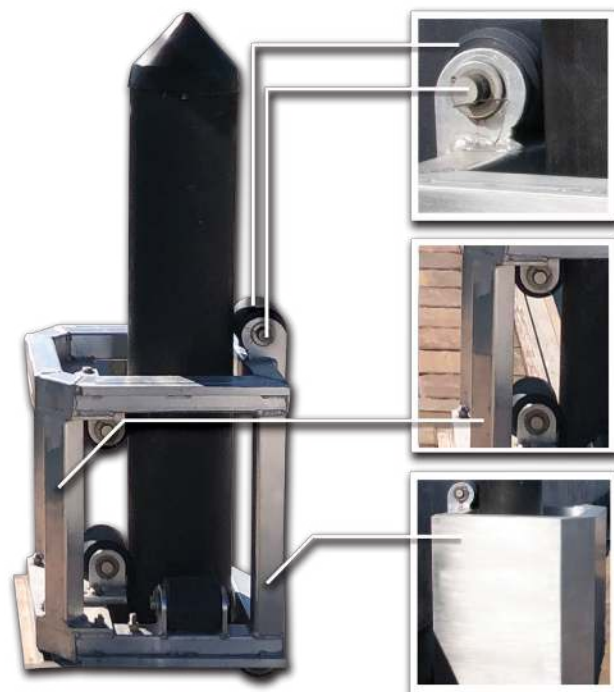
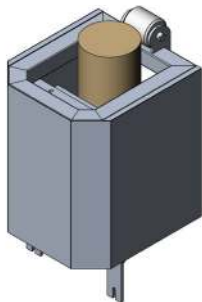

UHMW Rollers

Assembled with
300 Series
Stainless Steel
Hardware

Frame
Constructed
Using
6061-T6
Aluminum

Protective
Cowling
Constructed with
6061-T6
Aluminum

Patent Pending



Golden is ISO Certified and follows the guidelines of the ISO 9001 standard.